



**HBI Pre-Apprenticeship
Certificate Training (PACT)
Basic Carpentry Examination
A21 & A22**

Student Codes: 9015 and 9016 / Version: 01

Teacher Code: 9176 / Version: 01

Copyright © 2019. All Rights Reserved.

General Assessment Information

Blueprint Contents

General Assessment Information
Written Assessment Information

Specific Competencies Covered in the Test
Sample Written Items

Test Type: This certification assessment is a customized assessment for the Home Builders Institute. This assessment measures technical skills at the occupational level and includes items which gauge factual and theoretical knowledge. This assessment offers both a written and performance component and can be used at the secondary level and postsecondary level. This assessment can be delivered in an online or paper/pencil format.

Revision Team: The assessment content is based on input from secondary, post-secondary, and business/industry representatives from the state of Idaho, Florida, Maine, North Carolina, and Washington.



46.0201 – Carpentry



Career Cluster - Architecture
and Construction



47-2031.00 - Construction and
Related Workers, All Other

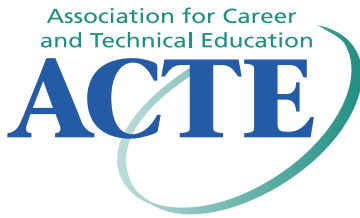

The Association for Career and Technical Education (ACTE), the leading professional organization for career and technical educators, commends all students who participate in career and technical education programs and choose to validate their educational attainment through rigorous technical assessments. In taking this assessment you demonstrate to your school, your parents and guardians, your future employers and yourself that you understand the concepts and knowledge needed to succeed in the workplace. Good Luck!



The Home Builders Institute (HBI) trains skilled workers for the building industry. Through pre-apprenticeship training, certification programs and job placement services, HBI provides graduates with the skills and experience they need to build a career and change their lives. HBI assessments, in partnership with the National Association of Home Builders (NAHB), are based on national skills standards set by industry professionals and educators. Participants passing the assessments are eligible for certification through HBI/NAHB at the entry, semi-skilled, or skilled levels.

Selection of curricula and instructional materials chosen to support assessment achievement must be obtained from material that has been aligned to the Residential Construction National Skill Standards and approved by HBI. For a current listing, please go to <http://www.hbi.org/curriculum/>

Visit www.hbi.org for more information.

Written Assessment

This written assessment consists of questions to measure an individual's factual theoretical knowledge.

Administration Time: 50 minutes

Number of Questions: 50

Number of Sessions: This assessment may be administered in one session.

Areas Covered

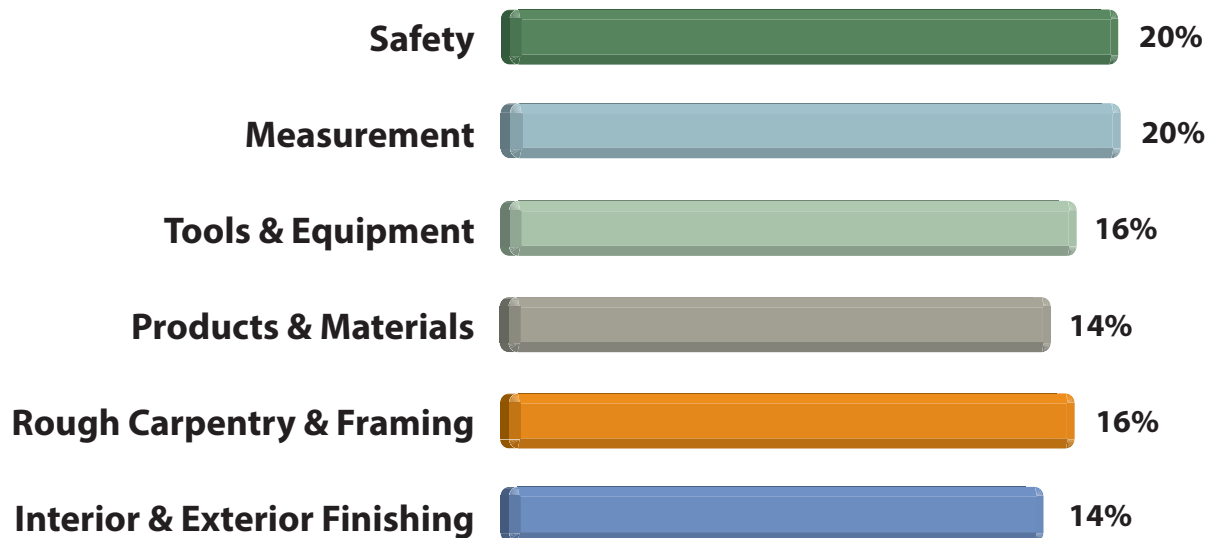

Specific Competencies and Skills Tested in this Assessment

Safety

- OSHA, Fire, Job Site, Tools, SDS, Personal Injuries, First Aid, and Gasoline

Measurement

- Fractions, Feet/Inches, Addition, Perimeter, Linear Feet, Ruler, Area, and Estimating Materials

Tools & Equipment

- Snips, Saws, Screw Heads, Circular Saws, Electric Drills, Belt Sander, Power Drill, Nail Set, Plumb, Saw Blades, Drilling, Screw Gun, and Table Saw

Products & Materials

- Sill Plate, Studs, Lumber, Fasteners, and Glue

Rough Carpentry & Framing

- Blueprint, Floor, Wall, Steel Framing, Roofing, Trusses, Concrete Forms, Floor Framing, and Platforms

Interior & Exterior Finishing

- Roof Framing, Siding, Windows, Drywall, Flooring, Insulation, and Cabinets



Sample Questions

Which of these accurately describes wood and lumber products?

- A. Hardwood lumber is usually purchased in the rough.
- B. The nominal size and actual size of lumber is the same.
- C. Lumber 2 inches and thicker is called timbers.
- D. All of the above

What is the total outside dimension (perimeter) of the slab shown?

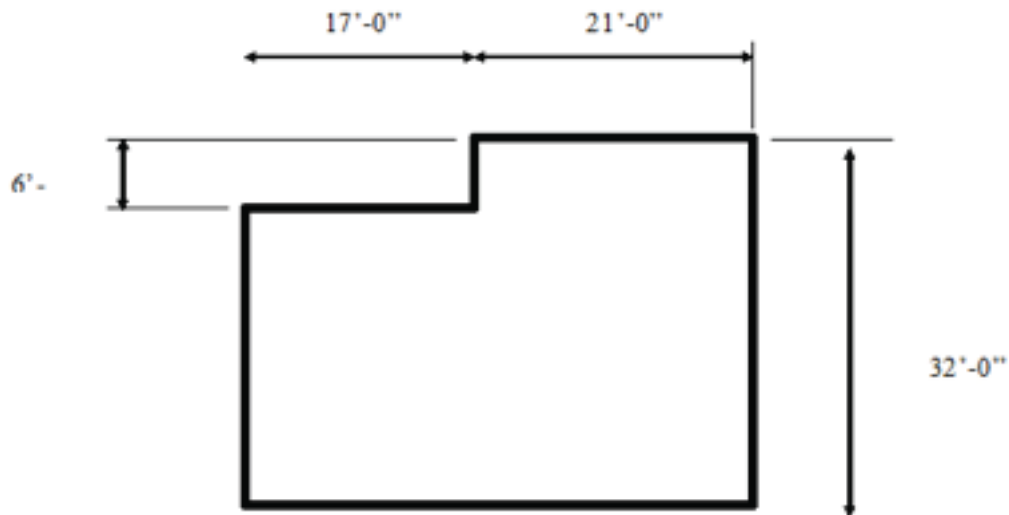

- A. 76 feet
- B. 102 feet
- C. 140 feet
- D. 280 feet

Sample Questions (continued)

What is the distance measured by line B?

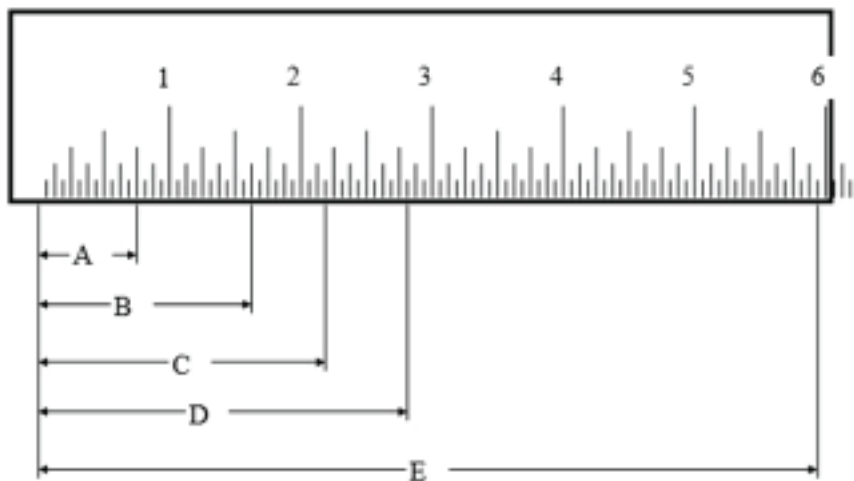

- A. 1-3/8 inches
- B. 1-5/8 inches
- C. 1-9/16 inches
- D. 1-3/4 inches

All of the following are recommended procedures for removing nails EXCEPT:

- A. tapping a cat's paw under the nail head with a hammer.
- B. tapping the claw of a crow bar under the nail head with a hammer.
- C. tapping a pry bar under the head of the nail head with a hammer.
- D. tapping the claw of a claw hammer under the nail head with another hammer.

Which of these grades of framing lumber is used most often for floor framing?

- A. No. 1
- B. 2 & BTR
- C. SEL STR
- D. Stud grade

How many total board feet are in twelve 2 x 4s 8 feet long?

- A. 64 board feet
- B. 20.4 board feet
- C. 16 board feet
- D. 5.3 board feet